

LEGEND

- ROOF OUTLINE
- ▨ 200 SERIES MASONRY

WINDOW & DOOR SCHEDULE

- W1 2010W x 900D SLIDING GLASS WINDOW
- RD 5210W x 3400H B&D ROLLER DOOR (DTC M/406/4)

Note: ALL PERSONAL ACCESS DOORS TO BE 900 WIDE x 2100 HIGH OPENING IN WALL w/ PM FRAME & 820 x 2040 TIMBER LEAF

FITTINGS & FIXTURES

- wc toilet
- sh shower
- b bath
- s sink
- r wardrobe
- wm washing machine
- hb hand basin
- db double hand basin
- lt laundry tub
- p pantry
- f fridge
- fw floor waste

Note:
BUILDER TO PROVIDE FLASHING/TRIMS & ENSURE WATERPROOFING IN ACCORDANCE WITH THE NCC

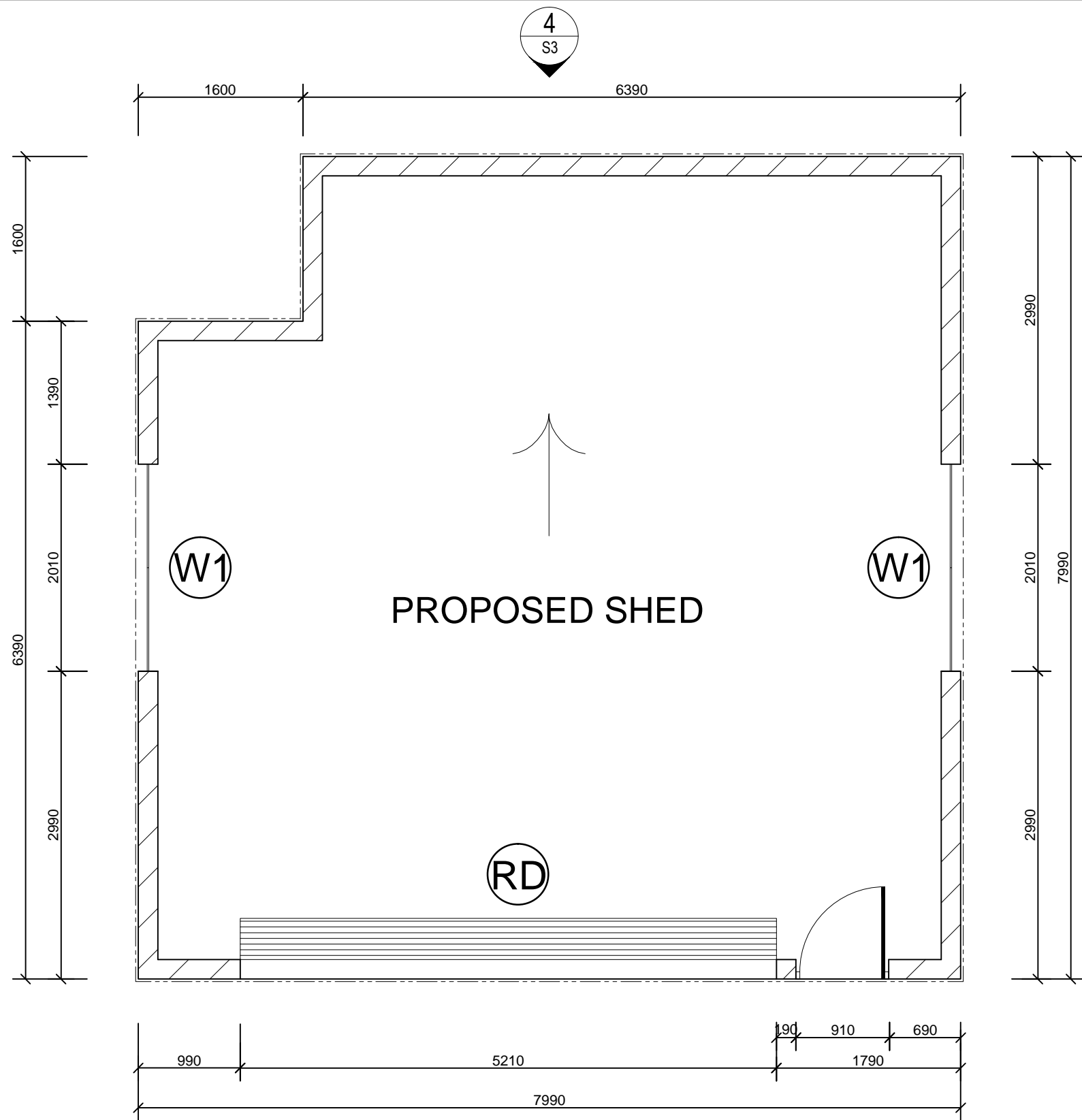

GROUND FLOOR PLAN
 SCALE 1:50

-	ISSUE FOR STRUCTURAL APPROVAL	14-02-2017	MC	NTCE
No.	DESCRIPTION	DATE	NAME	DEPT./COMPANY.
	AMENDMENTS			



Mobile: 0427 411 633 Email: ntce@westnet.com.au

N.T. Consulting Engineers
 ABN 73 102 631 186
 P.O. Box 900
 COOLALINGA 0839
 Northern Territory, Australia

DRAWN	OATS
DATE 14-02-2017	
DESIGNED	MC
DATE 14-02-2017	
STRUCTURALLY CONCURRED	
21/03/05	

CHECKED	MC
DATE 14-02-2017	
CHECKED	AH
DATE 14-02-2017	
PROJECT OFFICER	S.ONESTI
DATE 14-02-2017	

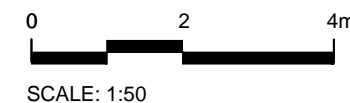





PROPOSED SHED				
SIMON ONESTI				
LOT 11320 (19) CURRIE CRESCENT, JOHNSTON				
GROUND FLOOR PLAN				
FILE No.	ASSET No.	SHEET No.	DRAWING No.	AMEND.
-	-	2 of 7	U732538-S2	-
				SHEET SIZE A3

LEGEND

 200 SERIES MASONRY B/B: 2-N16

Note:
SITE LEVELS SHOWN ARE
NOMINAL & ARE TO BE
CONFIRMED ON SITE

-  +4200 Top of Wall
-  +3400 RD Head
-  +2100 Lintel
-  ±0.00 FFL
-  -200 NGL

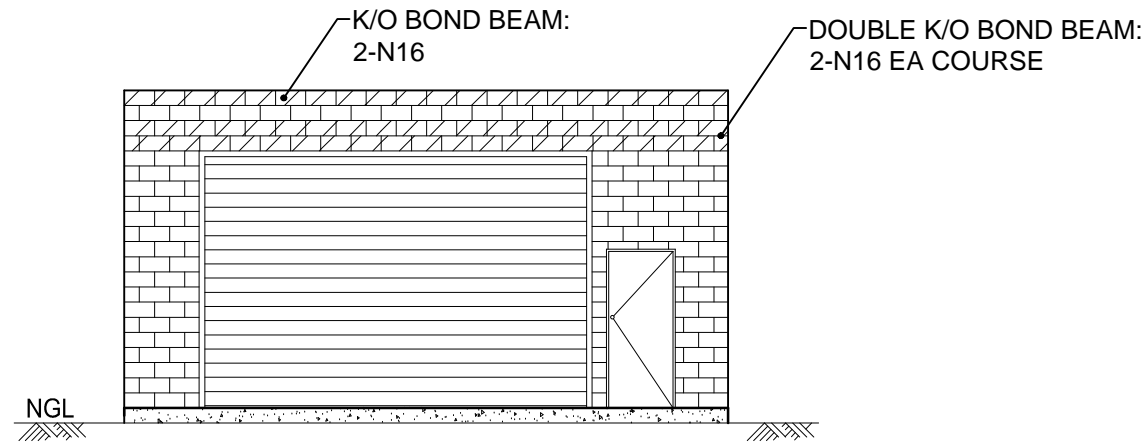



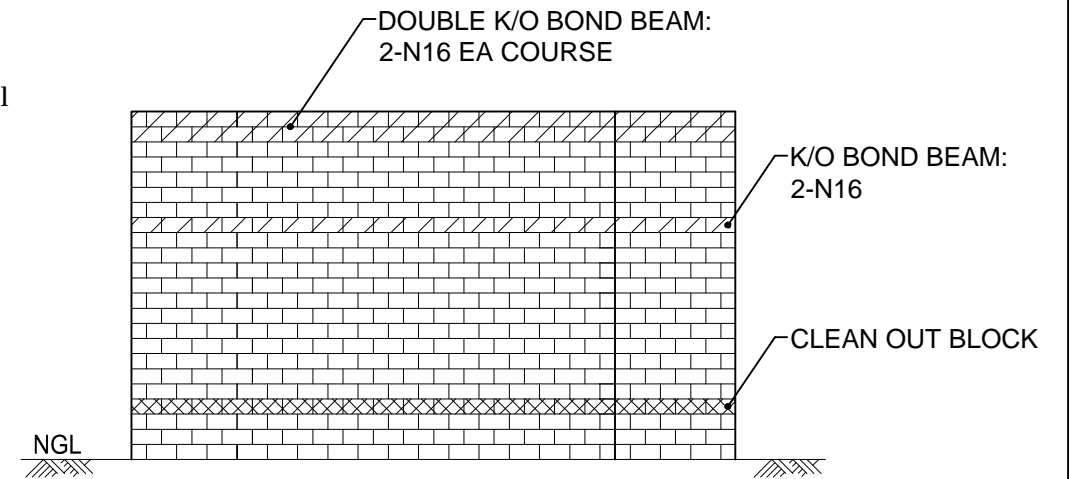

ELEVATION 3
SCALE 1:100

-  +3800 Top of Wall
-  +2200 B/B
-  ±0.00 FFL
-  -800 NGL



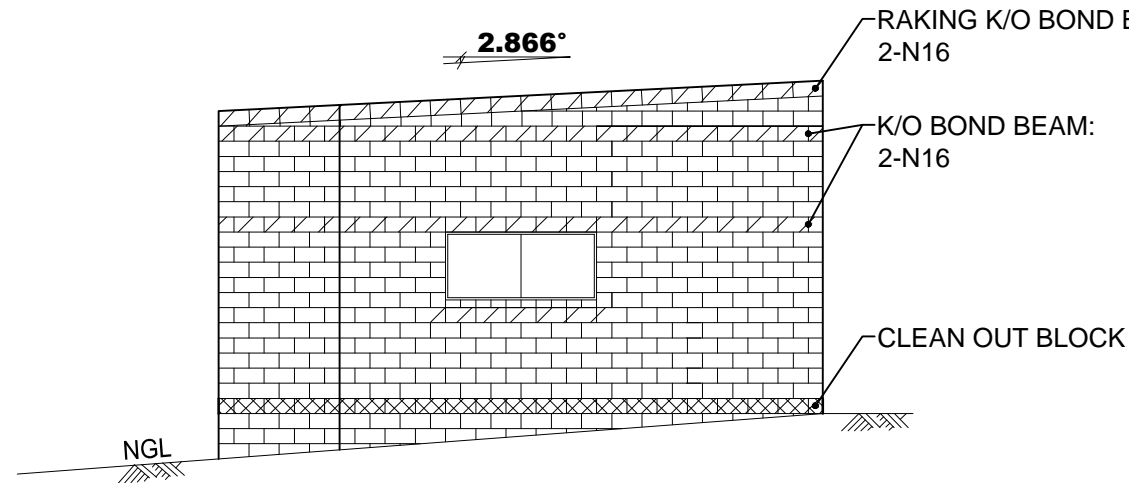

ELEVATION 4
SCALE 1:100

-  +3800 Top of Wall
-  +2400 B/B
-  +2200 Lintel
-  ±0.00 FFL
-  -600 NGL



ELEVATION 2
SCALE 1:100

-  +4200 Top of Wall
-  +3400 Lintel

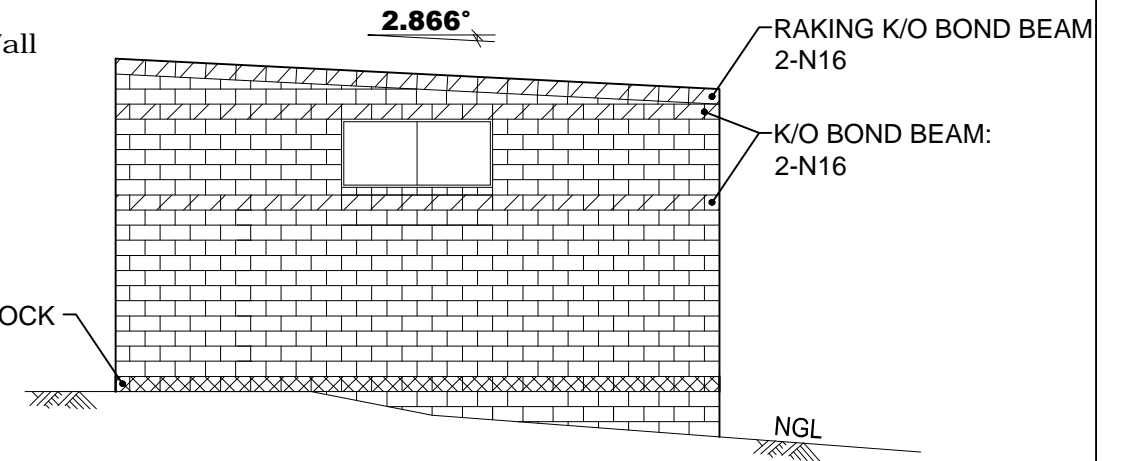

ELEVATION 3
SCALE 1:100

- ISSUE FOR STRUCTURAL APPROVAL		14-02-2017	MC	NTCE
No.	DESCRIPTION	DATE	NAME	DEPT./COMPANY.
	AMENDMENTS			

NT Consulting Engineers
N.T. Consulting Engineers
ABN 73 102 631 186
P.O. Box 900
COOLALINGA 0839
Northern Territory, Australia

Mobile: 0427 411 633 Email: ntce@westnet.com.au

DRAWN OATS DATE 14-02-2017	CHECKED MC DATE 14-02-2017
DESIGNED MC DATE 14-02-2017	CHECKED AH DATE 14-02-2017
STRUCTURALLY CONCIURED 21/03/05	PROJECT OFFICER S.ONESTI DATE 14-02-2017

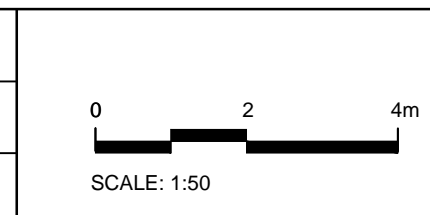

PROPOSED SHED SIMON ONESTI LOT 11320 (19) CURRIE CRESCENT, JOHNSTON ELEVATIONS					
FILE No.	ASSET No.	SHEET No.	DRAWING No.	AMEND.	SHEET SIZE
-	-	3 of 7	U732538-S3	-	A3